

Earth Tags

Technical Details

Material	Brass, Brass Bickel Plated Stainless Steel 304 Stainless Steel 316
----------	--

For more information see our webpage.

Size Selection Table

Thread Type	Sizes & Code Nr.											
METRIC	12	16	20	25	32	40	50	63	75	80	90	110
EN 60423 (M)	02	01	1	2	3	4	5	6	7	8	9	10
NPT	1/4	3/8	1/2	3/4	1	1 1/4	1 1/2	2				
ANSI B1.20.1 (N)	02	01	1	2	3	4	5	6				

Order Encoding

Size	Material	Code Examples
BMET	B (Brass)	BMET01B
BNET	BN (Brass Nickel Plated)	BNET1BN
	X304	BMET2X304
	X316	BMET01X316

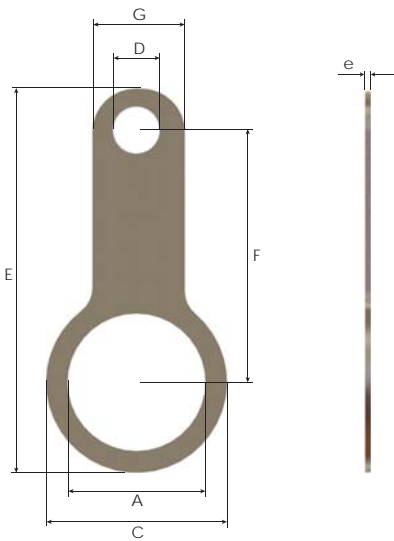

Type METRIC

Size	AØ mm	e mm	CØ mm	Dimensions DØ mm	E mm	F mm	G mm	Part Number
M12	12,20	1,5	22,0	6,2	46,00	30,0	12,0	BMET02
M16	16,20	1,5	25,0	6,2	48,75	30,0	12,5	BMET01
M20	20,20	1,5	28,6	6,2	53,55	33,0	12,5	BMET1
M25	25,20	1,5	34,0	6,2	59,50	36,0	13,0	BMET2
M32	32,20	1,5	42,0	12,2	73,00	41,0	22,0	BMET3
M40	40,20	1,5	54,0	14,2	86,50	46,5	26,0	BMET4
M50	50,20	1,5	67,0	14,2	111,50	63,5	29,0	BMET5
M63	63,20	1,5	77,0	14,2	125,50	72,5	29,0	BMET6
M75	75,20	1,5	89,0	14,2	137,50	77,0	32,0	BMET7
M80	80,20	1,5	100,0	14,2	158,0	91,5	32,0	BMET8
M90	90,20	1,5	109,5	14,2	167,00	94,5	35,5	BMET9
M110	110,20	1,5	138,0	14,2	214,00	125,0	40,0	BMET10

Type NPT

Size	AØ mm	e mm	CØ mm	Dimensions DØ mm	E mm	F mm	G mm	Part Number
NPT 1/4"	13,50	1,5	22,0	6,2	46,00	30,0	12,0	BNET02
NPT 3/8"	17,35	1,5	25,0	6,2	48,75	30,0	12,5	BNET01
NPT 1/2"	21,70	1,5	28,6	6,2	53,55	33,0	12,5	BNET1
NPT 3/4"	26,90	1,5	34,0	6,2	59,50	36,0	13,0	BNET2
NPT 1"	33,60	1,5	42,0	12,2	73,00	41,0	22,0	BNET3
NPT 1 1/4"	42,35	1,5	54,0	14,2	86,50	46,5	26,0	BNET4
NPT 1 1/2"	48,50	1,5	67,0	14,2	111,50	63,5	29,0	BNET5
NPT 2"	60,50	1,5	77,0	14,2	125,50	72,5	29,0	BNET6